

Tel-Tru Sanitary Pressure Gauge MODEL 83

PHARMA LINE

Model 83 sanitary gauges are accurate to $\pm .75\%$ full scale and have built-in, highly polished, totally flush 316L stainless steel diaphragm. They are designed with a unique pulsation dampening system, waterproof construction, and polycarbonate lenses, making them ideal for the most rigid sanitary requirements of the pharmaceutical industry.



Model 83



► SPECIFICATIONS:

Dial size/Accuracy:	2½" (63mm) $\pm .75\%$ FS 3½" (90mm) $\pm .75\%$ FS 5" (120mm) $\pm .75\%$ FS
Case:	304 SS, Food Grade Glycerine fill
Bezel:	304 SS
Wetted Materials:	316L SS diaphragm Ra < 8 microinches
Internal Materials:	Brass/bronze system/movement Mechanical dampening
Transmission Fluid:	Glycerine system fill
Connection Fitting:	1½" Tri-Clamp® Lower mount, center-back mount
Lens:	Polycarbonate
Pointer:	Aluminum with re-zero adjustment
Dial:	White aluminum
Ranges:	See chart: 30" Hg to 1000 psi
Scale:	PSI or dual PSI/Bar
Over range protection:	P max + 30%
Sanitary Standard:	Meets 3-A Sanitary Standard 74-07 requirements.
Traceable ID:	Marked with order and date code
Environmental Protection:	Waterproof, can be CIP

► TEMPERATURE LIMITS:

Process Temperature Range:	10°F to 250°F (-12°C to 121°C)*
Ambient Operating Limits:	25°F to 160°F (-4°C to 71°C)
Ambient Storage Limits:	0°F to 250°F (-18°C to 121°C)

*500°F (260°C) is maximum process temperature with high temperature option

► AVAILABLE OPTIONS:

- Dry case
- Connection locations - right, left, top mount
- 2, 2½, or 3" fittings
- High temperature option (>250°F ≤ 500°F) Viton® Seal
- Other fitting types (including **Cherry Burrell, APC**) and sizes are available on request.

► REPAIR SERVICE:

- Disassemble, clean, and inspect all components
- Replace/repair damaged or worn components
- Reassemble and calibrate to original factory specifications

► AVAILABLE CASE STYLES AND DIMENSIONS:

DIAL	Tri-Clamp Fitting	A	B	C	D	E	F	G
2583 2½"	1½"	2.5" (63.5mm)	3.81" (96.8mm)	1.99" (50.5mm)	1.31" (33.3mm)	.44" (11.2mm)	2.63" (66.8mm)	.56" (14.3mm)
	2"	2.5" (63.5mm)	3.81" (96.8mm)	2.52" (64mm)	1.31" (33.3mm)	.44" (11.2mm)	2.63" (66.8mm)	.56" (14.3mm)
3583 3½"	1½"	3.68" (93mm)	5.5" (140mm)	1.99" (50.5mm)	1.88" (48mm)	.63" (16mm)	3.75" (95mm)	.88" (22mm)
	2"	3.68" (93mm)	5.5" (140mm)	2.52" (64mm)	1.88" (48mm)	.63" (16mm)	3.75" (95mm)	.88" (22mm)
5083 5"	1½"	5.06" (129mm)	7" (178mm)	1.99" (50.5mm)	2.3" (59mm)	.63" (16mm)	4.19" (104mm)	.88" (22mm)
	2"	5.06" (129mm)	7" (178mm)	2.52" (64mm)	2.3" (59mm)	.63" (16mm)	4.19" (107mm)	.88" (22mm)

► MODEL CODES:

2583	Pharma, 2½" dial
3583	Pharma, 3½" dial
5083	Pharma, 5" dial

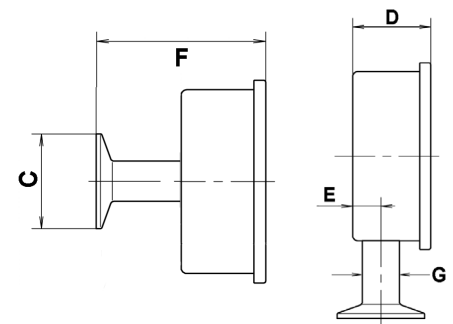
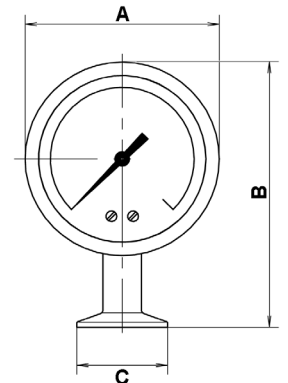

Tel-Tru Manufacturing Company

408 St. Paul St., Rochester, New York 14605 USA

Phone: 585.232.1440 • 800.232.5335 • Fax: 585.232.3857 • E-mail: info@teltru.com • Web: www.teltru.com

Tel-Tru Sanitary Pressure Gauge MODEL 83

PHARMA LINE

How to Order

Ordering Example: Pharma, 2½" dial, 316L SS wetted parts, 304 SS case, 1½" connection size, Lower location, Tri-Clamp connection type, 0-160 psi & 0-11 bar range, Dry case.

A
B
C
D
E
F
G
H
I

2
5
8
3
1
S
8
L
A
E
4
F
*
T

Key: X = Available S = Standard

Code	Description		Available			
A	Model		<div style="display: flex; flex-direction: column; align-items: center;"> 2583 3583 5083 </div>			
	2583	Pharma, 2½" dial				
	3583	Pharma, 3½" dial				
	5083	Pharma, 5" dial				
B	Materials - Wetted Parts					
	1	316L SS	S	S	S	
C	Case					
	S	304 SS	S	S	S	
D	Connection Size					
	8	1½"	X	X	X	
	9	2"	X	X	X	
	E	2½"	X	X	X	
	F	3"	X	X	X	
E	Connection Location					
	C	Center Back	X	X	X	
	L	Lower	X	X	X	
	V	Right Side	X	X	X	
	W	Left Side	X	X	X	
F	Connection Type					
	A	Tri-Clamp	S	S	S	
	J	G&H "H" Line Male	X	X	X	
	K	Cherry-Burrell Male I-Line	X	X	X	
	N	DIN40 (accord. to DIN 11851)	X	X	X	
	P	DIN50 (accord. to DIN 11851)	X	X	X	
	Q	SMS38	X	X	X	
	R	SMS51	X	X	X	
G	Range and Scale					
	XXX	See Range Chart				
H	Options* Insert codes only if required					
	L	Glass Lens	X	X	X	
	D	Drag Pointer		X	X	
	O	Extra Dampening	X	X	X	
	I	High Temperature Option Process temp. >250°F	X	X	X	
I	Case Fill					
	G	Glycerine Filled	S	S	S	
	T	Dry Case	X	X	X	

* See Ordering Example, top of page.
 Other fitting types and sizes are available on request.
 Other case fill materials and transmission fluids are available on request.

Shipping weight approximately 3lbs. (1.3kg)

Teflon® is a registered trademark of E. I. du Pont de Nemours and Company or its affiliates.

Tri-Clamp® is a registered trademark of Tri-Clover, Inc.

Viton is a registered trademark of DuPont Performance Elastomers.

Ranges

	CODE
0-30 psi	C6A
0-60 psi	D6A
0-100 psi	D9A
0-160 psi	E4A
0-200 psi	E5A
0-300 psi	E8A
0-400 psi	F2A
0-600 psi	F4A
0-1000 psi	F8A
30-0-30 psi	Z2A
30-0-60 psi	Z3A
30-0-100 psi	Z4A
30-0-150 psi	U6A
30-0-200 psi	Z6A
30-0-300 psi	Z7A
0-30 psi & 0-2 bar	C6F
0-60 psi & 0-4 bar	D6F
0-100 psi & 0-7 bar	D9F
0-160 psi & 0-11 bar	E4F
0-200 psi & 0-14 bar	E5F
0-300 psi & 0-20 bar	E8F
0-400 psi & 0-28 bar	F2F
0-600 psi & 0-40 bar	F4F
0-1000 psi & 0-70 bar	F8F
30-0-30 psi & 1-0-2 bar	Z2Z
30-0-60 psi & 1-0-4 bar	Z3Z
30-0-100 psi & 1-0-7 bar	Z4Z
30-0-150 psi & 1-0-10 bar	U6Z
30-0-200 psi & 1-0-15 bar	Z6Z
30-0-300 psi & 1-0-20 bar	Z7Z

Other ranges are available, including PSI/Kg/cm² and PSI/KPa.

Repair Service

(order separately)

- RSPG83-25** 2½" Pharma Line pressure gauges
- RSPG83-35** 3½" Pharma Line pressure gauges
- RSPG83-50** 5" Pharma Line pressure gauges

Certificates

(order separately)

- 10000016** Material Certificate
- 10000002** Calibration Certificate

Product specifications and pricing are subject to change without notice.



Tel-Tru Manufacturing Company

408 St. Paul St., Rochester, New York 14605 USA
 Phone: 585.232.1440 • 800.232.5335 • Fax: 585.232.3857
 E-mail: info@teltru.com • Web: www.teltru.com